

Installation Key:

- A. Installation tool
- B. Retention tab
- C. Compression tabs
- D. Cloth-catching teeth

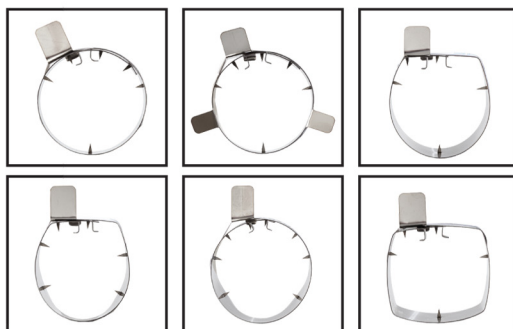

1

Remove the foam plug.
CAUTION: SHARP EDGES. BAND CAN SPRING OPEN CAUSING POSSIBLE INJURY. Do not touch the inside of the device once the foam is removed as contact with hooks can cause serious injury.

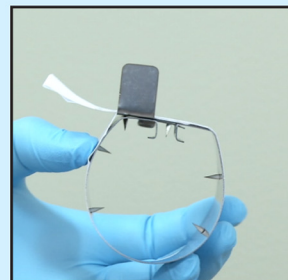

2

Place the installation tool (sold separately) on the compression tabs. Make sure the metal retention tab is pointing up. Squeeze the installation tool to compress Traptex while maintaining pressure on the compression tabs, then remove the adhesive label.

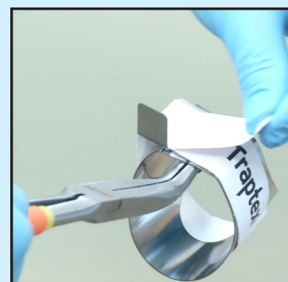
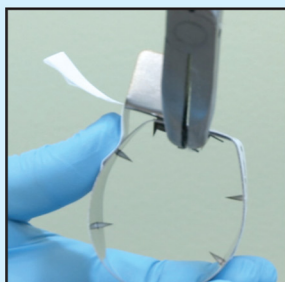

3

Place Traptex into the drain opening with the metal retention tab pointing up until retention tab touches the bowl. Slowly release the installation tool from the compression tabs. Traptex will expand to fit the drain opening. If necessary, use the installation tool to tap Traptex into a more secure position until the retention tab is flush against the back of the toilet. The device should be flush with the drain opening.

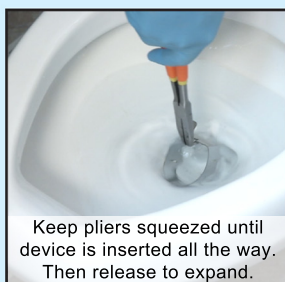

4

Post the sharp edges warning sign (included) near each toilet with a Traptex installed. Contact us for additional posters.



5

Never put your hands into the toilet once Traptex is installed. Once installed, the toilet bowl can be cleaned as usual - you do not need to remove Traptex to clean the toilet. Use bristled toilet brushes with Traptex for best results. Do not attempt to remove Traptex without proper tools. Improper removal can result in Traptex releasing and springing open, causing possible injury. Use retriever tool to remove items caught by Traptex.

